

# Gemeinde Glarus Nord

## Revision Ortsplanung Öffentliche Auflage

### Waldfeststellungsplan 1: 2'000

### Jörgi, Hohrainstauden, Hohrain und Sitli Mühlehorn

Waldfeststellungsverfahren gemäss Art. 13, Bundesgesetz über den Wald und Art. 9, kantonales Einführungsgesetz zum Bundesgesetz über den Wald

Kanton Glarus, Abteilung Wald und Naturgefahren

Dani Rüegg  
Abteilungsleiter

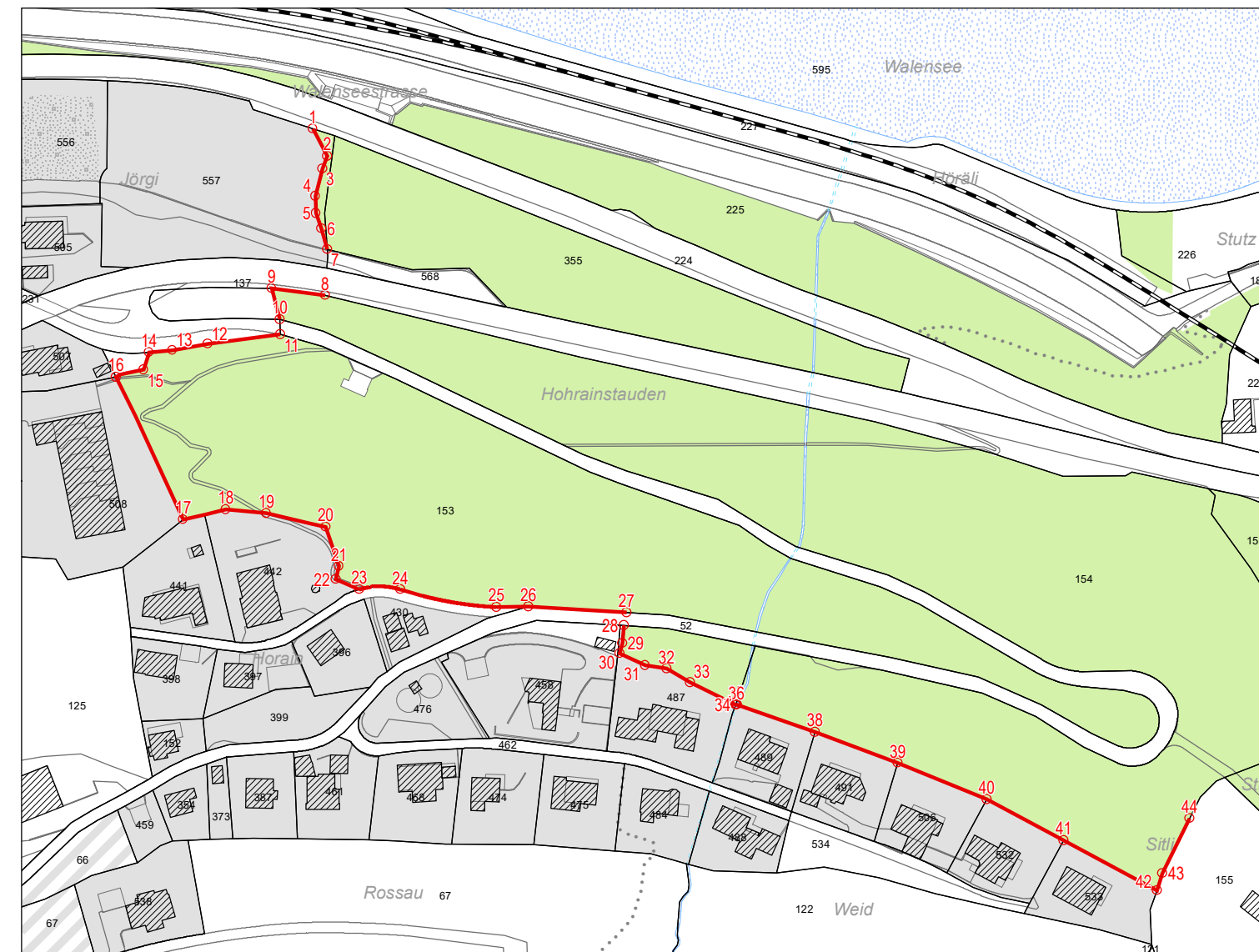

#### Koordinatenverzeichnis

##### Jörgi, Mühlehorn

Nr.	X	Y
1	2'732'030.96	1'219'839.13
2	2'732'035.40	1'219'830.58
3	2'732'033.91	1'219'826.52
4	2'732'031.67	1'219'817.88
5	2'732'031.96	1'219'812.32
6	2'732'033.63	1'219'807.52
7	2'732'035.42	1'219'800.86

##### Sitli, Mühlehorn

Nr.	X	Y
28	2'732'129.61	1'219'681.55
29	2'732'129.08	1'219'675.90
30	2'732'128.33	1'219'672.70
31	2'732'136.36	1'219'668.95
32	2'732'143.23	1'219'667.85
33	2'732'150.62	1'219'663.55
34	2'732'165.13	1'219'656.41
35	2'732'165.14	1'219'656.40
36	2'732'165.42	1'219'656.31
37	2'732'165.48	1'219'656.42
38	2'732'190.21	1'219'647.72
39	2'732'216.52	1'219'637.87
40	2'732'244.84	1'219'626.34
41	2'732'269.16	1'219'613.37
42	2'732'298.84	1'219'597.50
43	2'732'300.65	1'219'602.80
44	2'732'309.22	1'219'620.23

##### Hohrainstauden, Mühlehorn

Nr.	X	Y
8	2'732'034.78	1'219'786.25
9	2'732'017.84	1'219'788.55
10	2'732'020.33	1'219'778.70

##### Hohrain, Mühlehorn

Nr.	X	Y
11	2'732'020.52	1'219'773.88
12	2'731'997.53	1'219'770.85
13	2'731'986.28	1'219'768.92
14	2'731'978.93	1'219'768.09
15	2'731'977.15	1'219'762.70
16	2'731'968.36	1'219'760.41
17	2'731'989.76	1'219'715.17
18	2'732'003.34	1'219'718.35
19	2'732'016.17	1'219'717.23
20	2'732'035.01	1'219'712.79
21	2'732'039.26	1'219'700.37
22	2'732'038.15	1'219'696.20
23	2'732'045.60	1'219'693.01
24	2'732'058.72	1'219'692.93
25	2'732'089.14	1'219'687.39
26	2'732'099.38	1'219'687.56
27	2'732'130.43	1'219'685.65

#### Festlegungsinhalt

##### Waldfeststellung

— neu

##### Hinweise

- Baugebiet
- Wald
- Gewässer
- Gebäude

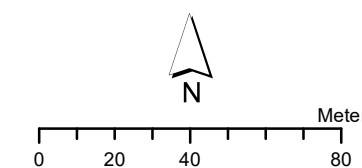

Gäugelistrasse 7 Tel: 081 254 38 20  
CH-7000 Chur Fax: 081 254 38 21  
info@stw.ch www.stw.ch  
Objekt: 25091 Format: 63 / 29.7 cm