

# Gemeinde Glarus Nord

## Revision Ortsplanung Öffentliche Auflage

### Waldfeststellungsplan 1: 2'000

#### Jörgi, Hohrainstauden, Hohrain und Sitli Mühlehorn

Waldfeststellungsverfahren gemäss Art. 13, Bundesgesetz über den Wald und Art. 9, kantonales Einführungsgesetz zum Bundesgesetz über den Wald

Kanton Glarus, Abteilung Wald und Naturgefahren

Dani Rüegg  
Abteilungsleiter

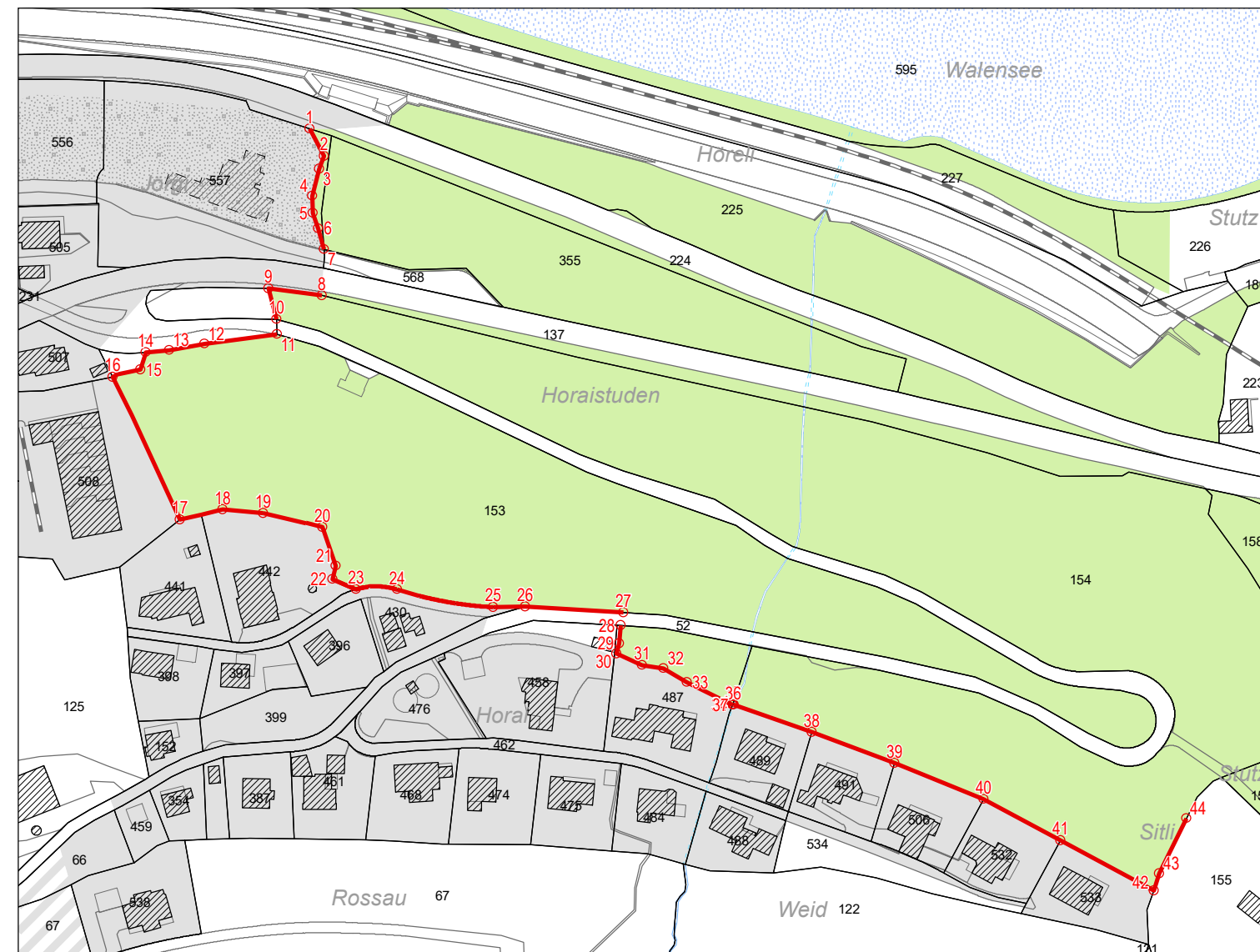

#### Festlegungsinhalt

Waldfeststellung

— neu

#### Hinweise

- Baugebiet
- Zone für künftige bauliche Nutzung
- Wald
- Gewässer
- Gebäude

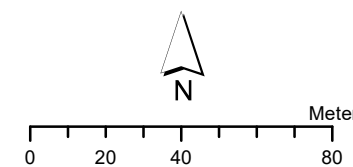

#### Koordinatenverzeichnis

Jörgi, Mühlehorn

Nr.	X	Y
1	2'732'030.96	1'219'839.13
2	2'732'035.40	1'219'830.58
3	2'732'033.91	1'219'826.52
4	2'732'031.67	1'219'817.88
5	2'732'031.96	1'219'812.32
6	2'732'033.63	1'219'807.52
7	2'732'035.42	1'219'800.86

Hohrainstauden, Mühlehorn

Nr.	X	Y
8	2'732'034.78	1'219'786.25
9	2'732'017.84	1'219'788.55
10	2'732'020.33	1'219'778.70

Hohrain, Mühlehorn

Nr.	X	Y
11	2'732'020.52	1'219'773.88
12	2'731'997.53	1'219'770.85
13	2'731'986.28	1'219'768.92
14	2'731'978.93	1'219'768.09
15	2'731'977.15	1'219'762.70
16	2'731'968.36	1'219'760.41
17	2'731'989.76	1'219'715.17
18	2'732'003.34	1'219'718.35
19	2'732'016.17	1'219'717.23
20	2'732'035.01	1'219'712.79
21	2'732'039.26	1'219'700.37
22	2'732'038.15	1'219'696.20
23	2'732'045.60	1'219'693.01
24	2'732'058.72	1'219'692.93
25	2'732'089.14	1'219'687.39
26	2'732'099.38	1'219'687.56
27	2'732'130.43	1'219'685.65

Sitli, Mühlehorn

Nr.	X	Y
28	2'732'129.61	1'219'681.55
29	2'732'129.08	1'219'675.90
30	2'732'128.33	1'219'672.70
31	2'732'136.36	1'219'668.95
32	2'732'143.23	1'219'667.85
33	2'732'150.62	1'219'663.55
34	2'732'165.13	1'219'656.41
35	2'732'165.14	1'219'656.40
36	2'732'165.42	1'219'656.31
37	2'732'165.48	1'219'656.42
38	2'732'190.21	1'219'647.72
39	2'732'216.52	1'219'637.87
40	2'732'244.84	1'219'626.34
41	2'732'269.16	1'219'613.37
42	2'732'298.84	1'219'597.50
43	2'732'300.65	1'219'602.80
44	2'732'309.22	1'219'620.23